

# SHARP®

## 4T-C50AH1X

# AQUOS

### LED BACKLIGHT TV

#### EN - Initial setup guide

- Please read "Important safety precautions" before setting up the TV.

#### CS - 初始设置指南

- 在设置电视前，请阅读“关于安全的重要注意事项”。

#### FR - Guide d'installation initiale

- Veuillez lire les « Précautions de sécurité importantes » avant d'installer le téléviseur.

#### PT - Guia de configuração inicial

- Antes de começar a configurar o televisor, leia as "Importantes Precauções de Segurança".

#### ID - Panduan penyediaan awal





- Harap baca "Tindakan pencegahan penting untuk keselamatan" sebelum menyiapkan TV.

#### AR - دليل الإعداد الأولي

- يرجى قراءة "تنبيهات احتياطية هامة حول السلامة" قبل إعداد التلفزيون.

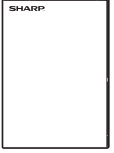
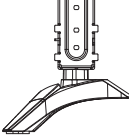
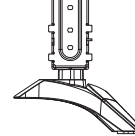

## A. Supplied accessories

① Remote control unit ( x 1) 	② "AAA" size battery ( x 2) 	③ Initial setup guide 
④ Stand unit 	⑤ Stand base with letter "L" 	⑥ Stand base with letter "R" 
⑦ Screws ( x 4) 		

	A	①	②	③
CS	随机附件	遥控器 ( x 1)	"AAA" 型号电池 ( x 2)	初始设置指南
FR	Accessoires fournis	Télécommande ( x 1)	Pile de format « AAA » ( x 2)	Guide d'installation initiale
PT	Acessórios fornecidos	Controlo remoto ( x 1)	Pilha de tamanho "AAA" ( x 2)	Guia de configuração inicial
ID	Aksesori yang disertakan	Unit remote kontrol ( x 1)	Baterai ukuran "AAA" ( x 2)	Panduan penyediaan awal
AR	الكماليات المرفقة	وحدة التحكم عن بعد ( x 1)	بطارية من حجم "AAA" ( x 2)	دليل الإعداد الأولي

	④	⑤	⑥	⑦
CS	底座组件	有 "L" 字母的底座	有 "R" 字母的底座	螺丝钉 ( x 4)
FR	Ensemble du socle	Tenez la base avec la lettre « L »	Tenez la base avec la lettre « R »	Vis ( x 4)
PT	Pedestal	Base do suporte com letra "L"	Base do suporte com letra "R"	Parafusos ( x 4)
ID	Unit dudukan	Dasar dudukan dengan huruf "L"	Dasar dudukan dengan huruf "R"	Sekrup ( x 4)
AR	حامل الجهاز	قاعدة حامل عليها حرف "L"	قاعدة حامل عليها حرف "R"	البراغي (عدد 4)

TINS-H087WJZZ  
18P07-MA-NP

EN - 1

EN - 2

## B. Inserting the batteries

### Remote control unit

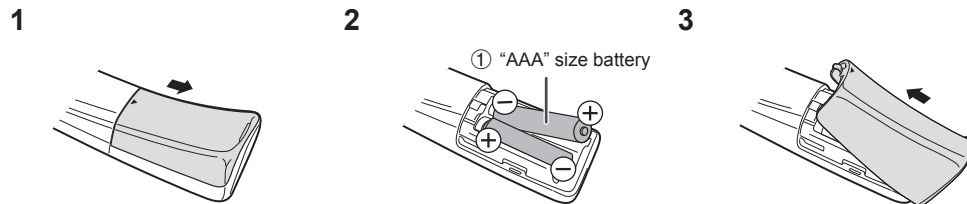

	B	①
CS	装入电池	“AAA” 型号电池
FR	Insertion des piles	Pile de format « AAA »
PT	Colocar as pilhas	Pilha de tamanho “AAA”
ID	Memasukkan Baterai	Baterai ukuran “AAA”
AR	ادخال البطاريات	بطارية من حجم “AAA”

### CAUTION

- Batteries (battery pack or batteries installed) shall not be exposed to excessive heat such as sunshine, fire or the like.

CS	<p><b>警告</b></p> <ul style="list-style-type: none"> <li>不要将电池（电池组或电池已被安装）暴露在如直射阳光、火等一些过热的环境中。</li> </ul>
FR	<p><b>ATTENTION</b></p> <ul style="list-style-type: none"> <li>Les piles (ou le bloc-piles) ne doivent pas être exposées à une source de chaleur excessive, telle que les rayons du soleil, un feu, etc.</li> </ul>
PT	<p><b>CUIDADO</b></p> <ul style="list-style-type: none"> <li>A pilhas (módulo de pilha ou pilhas instaladas), não deve ser exposta a calor excessivo, seja por exposição ao sol, fogo ou outras fontes de calor.</li> </ul>
ID	<p><b>PERHATIAN</b></p> <ul style="list-style-type: none"> <li>Baterai (kemasan baterai atau baterai terpasang) tidak boleh terpapar pada panas yang berlebihan seperti cahaya matahari, api atau sejenisnya.</li> </ul>
AR	<p><b>تنبيه</b></p> <ul style="list-style-type: none"> <li>لا ينبغي تعريض البطارية (حزمة البطارية أو البطارية المركبة) إلى الحرارة الزائدة. مثل أشعة الشمس أو النار أو ما شابه.</li> </ul>

## C. Attaching the stand unit

1

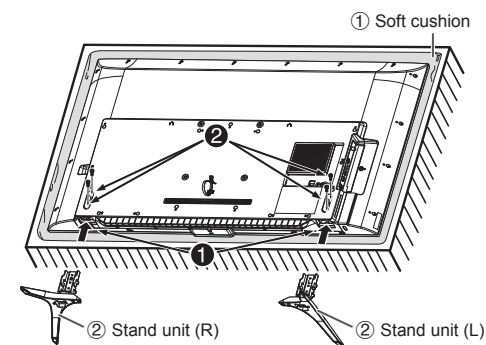

2

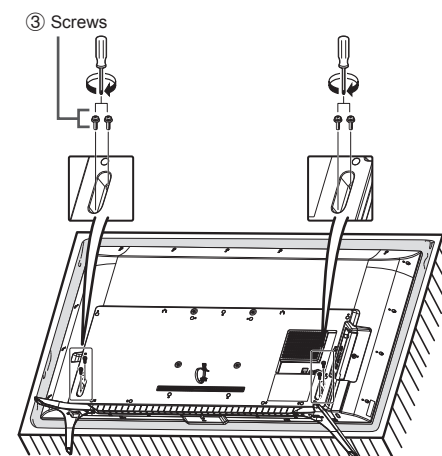

	①	②	③
CS	软衬垫	底座组件 (R) 底座组件 (L)	螺丝钉
FR	Coussin moelleux	Ensemble du socle (R) Ensemble du socle (L)	Vis
PT	Almofada macia	Pedestal (R) Pedestal (L)	Parafusos
ID	Bantalan lunak	Unit dudukan (R) Unit dudukan (L)	Sekrup
AR	حشية لينة	حامل الجهاز (R) حامل الجهاز (L)	البراغي

## Dear SHARP customer

Thank you for your purchase of the SHARP LCD colour TV product. To ensure safety and many years of trouble-free operation of your product, please read the Important Safety Precautions carefully before using this product.

## Important Safety Precautions

[ENGLISH 

- Stand base must be attached to prevent the TV set from falling down and cause injuries.
- Cleaning — Unplug the AC cord from the AC outlet before cleaning the product. Use a soft damp cloth to clean the product. Do not use liquid cleaners, aerosol cleaners or chemical cloth to clean it, as such materials may damage the product.
- Water and moisture — Do not use the product near water, such as bathtub, washbasin, kitchen sink, laundry tub, swimming pool and in a wet basement.
- Do not place vases or any other water-filled containers on this product. The water may spill onto the product causing fire or electric shock.
- Stand — Do not place the product on an unstable cart, stand, tripod or table. Doing so can cause the product to fall, resulting in serious personal injuries as well as damage to the product. Use only a cart, stand, tripod, bracket or table recommended by the manufacturer or sold with the product. When mounting the product on a wall, be sure to follow the manufacturer's instructions. Use only the mounting hardware recommended by the manufacturer.
- When relocating the product placed on a cart, it must be moved with utmost care. Sudden stops, excessive force and uneven floor surface can cause the product to fall from the cart.
- Ventilation — The vents and other openings in the cabinet are designed for ventilation. Do not cover or block these vents and openings since insufficient ventilation can cause overheating and/or shorten the life of the product. Do not place the product on a bed, sofa, rug or other similar surface, since they can block ventilation openings. This product is not designed for built-in installation; do not place the product in an enclosed place such as a bookcase or rack, unless proper ventilation is provided or the manufacturer's instructions are followed.
- The LCD panel used in this product is made of glass. Therefore, it can break when the product is struck forcefully or with a sharp object. If the LCD panel is broken, be careful not to be injured by broken glass.
- Heat sources — Keep the product away from heat sources such as radiators, heaters, stoves and other heat-generating products (including amplifiers).
- To prevent fire, never place any type of candle or naked flames on the top or near the TV set.
- To prevent fire or shock hazard, do not place the AC power cord under the TV set or other heavy items.
- Do not place heavy objects on this product or stand on it. Doing so could cause injury if the product overturns. Take special care near children and pets.
- The LCD panel is a very high technology product with 8,294,400 pixels, giving you fine picture details. Due to the very large number of pixels, occasionally a few non-active pixels may appear on the screen as a fixed point of blue, green or red. This is within product specifications and does not constitute a fault.
- **Precautions when transporting the TV**
  - When transporting the TV, never carry it by holding or otherwise putting pressure onto the display. Be sure to always carry the TV by two people holding it with two hands — one hand on each side of the TV.
- Do not display a still picture for a long time, as this could cause an afterimage to remain.
- Install the product on the place where the AC cord can be unplugged easily from the AC outlet or from the AC INPUT terminal on the rear of the product.
- If a television is not positioned in a sufficiently stable location, it can be potentially hazardous due to falling. Many injuries, particularly to children, can be avoided by taking simple precautions such as:
  - Using cabinets or stands recommended by the manufacturer of the television.
  - Only using furniture that can safely support the television.
  - Ensuring the television is not overhanging the edge of the supporting furniture.
  - Not placing the television on tall furniture (for example, cupboards or bookcases) without anchoring both the furniture and the television to a suitable support.
  - Not standing the televisions on cloth or other materials placed between the television and supporting furniture.
  - Educating children about the dangers of climbing on furniture to reach the television or its controls.
- Do not install the TV in a location in which it will be subject to water drops such as underneath an air conditioning unit or in the vicinity of a humidifier.
  - Water drops falling onto the TV and water entering inside it may result in fire, electric shock, or malfunctions.
  - We recommend that you install the TV at least 1m away from the outlet of an air conditioner.

## Initial installation

Follow the steps below one by one when using the TV for the first time. Some steps may not be necessary depending on your TV installation and connection.

- ❶ Connect an antenna cable to the antenna terminal.

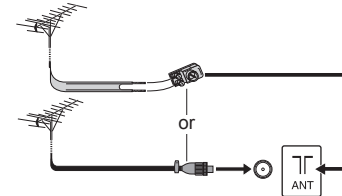

- ❷ Plug the AC cord into the AC outlet.

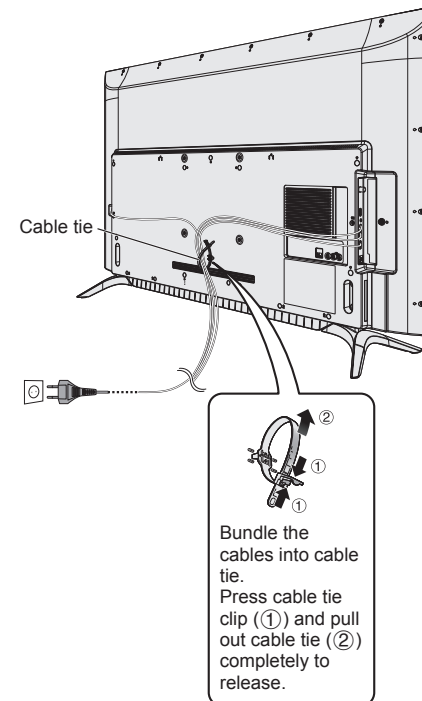

- ❸ Press One Button Key (Single Press) on the TV.

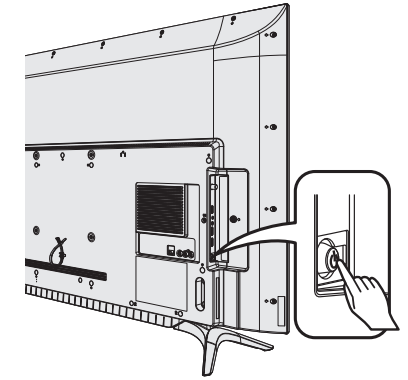

- ❹ Run the initial installation.
- Follow the guide on the TV screen to set the following settings.

- Language setting
- Location setting
- TV Location setting
- Channel search setting
- Smart TV setting
- SHARP Legal setting
- Completed

- Place the TV close to the AC outlet, and keep the power plug within reach.
- Product shape varies in some countries.

Viewing E-Manual

Viewing the Built-in Operation Manual

Displays the built-in operation manual on the screen. You can read information about how to use this device.

- 1 Press (**HOME**) to display the HOME screen, and then press to select "Settings". Press , press to select "Manual", and then press **ENTER**. This displays the built-in operation manual screen.
- 2 When you select contents, its page will be displayed.

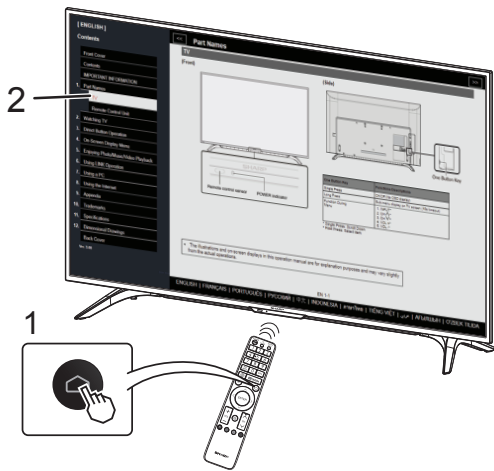

Appendix

Troubleshooting

The problems described below are not always caused by malfunctions. Check the TV again before having the TV serviced.

Problem	Possible Solution
• No power.	<ul style="list-style-type: none"><li>• Check if you pressed <b>POWER</b> on the remote control unit.</li><li>• Is the AC cord disconnected?</li><li>• Has the power been turned on?</li></ul>
• Remote control unit does not operate.	<ul style="list-style-type: none"><li>• Are batteries inserted with polarity (+, -) aligned?</li></ul>
• No picture.	<ul style="list-style-type: none"><li>• Is connection to other components correct?</li></ul>
• No sound.	<ul style="list-style-type: none"><li>• Is connection to other components correct?</li></ul>

CLEARING THE PASSWORD

If you forget the password, clear the password using the following procedure.

- 1 From the HOME screen, select "Settings" > "Menu", and then press to select "Initial setup".
- 2 Press / to select "Child lock", and then press **ENTER** and the password input screen display.
- 3 If you enter "3001" using **0 – 9**, the "Child lock" setting menu will be displayed.
- 4 Press / to select "Set password", and then press **ENTER** to set the password.
- 5 Enter the 4-digit number as a password using **0 – 9**, and then enter the same 4-digit to confirm. The new password is now set.

Specifications

Item		Model	4T-C50AH1X
LCD panel			126 cm
Resolution			8,294,400 pixels (3840 × 2160)
Video colour system			PAL/SECAM/NTSC 3.58/NTSC 4.43/PAL 60
TV function	TV-standard	Analogue	PAL: B/G, D/K, I SECAM: B/G, D/K, K/K1 NTSC: M
		Digital	DVB-T / DVB-T2
	Receiving channel	VHF/UHF	44.25—863.25 MHz
		CATV	S1—S41 ch (including Hyperband)
	TV-tuning system		Auto Preset 99 ch
		STEREO/BILINGUAL	NICAM: B/G, I, D/K A2 stereo: B/G MTS: M
Audio amplifier			10 W × 2
Terminals	ANT (Antenna input)		UHF/VHF 75 Ω DIN type
	SERVICE ONLY		φ 3.5 mm jack
	INPUT 1 (ARC) HDMI		HDMI (HDMI input), ARC
	INPUT 2 HDMI		HDMI (HDMI input)
	INPUT 3		AUDIO in, VIDEO in
	AUDIO OUT		AUDIO out, Headphone (φ 3.5 mm stereo)
	USB		USB (DC5V 1.5A output)
		ETHERNET (10/100 BASE-T)	Network connector
OSD language			English/Simplified Chinese/Arabic/French/Portuguese/Russian/Persian/Thai/Vietnamese/Indonesia/Hebrew/Hindi/Malay
Power requirement			AC 110 — 240 V, 50/60 Hz
Power consumption			140 W (0.5 W Standby)
Dimensions	without stand		1122 (W) × 666 (H) × 74 (D) mm
	with stand		1122 (W) × 708 (H) × 253 (D) mm
Weight without stand (with stand)			12.0 kg (12.5 kg)
Operating temperature			0°C to +40°C

- As a part of policy of continuous improvement, SHARP reserves the right to make design and specification changes for product improvement without prior notice. The performance specification figures indicated are nominal values of production units. There may be some deviations from these values in individual units.
- Specification may differ depending on the selected country.

CAUTION

- Installing the Liquid Crystal Television requires special skill that should only be performed by qualified service personnel. Customers should not attempt to do the work themselves. SHARP bears no responsibility for improper mounting or mounting that results in accident or injury.
- Carefully read the instructions that come with the bracket before beginning work.

Appendix

Trademarks

Manufactured under license from Dolby Laboratories. Dolby, Dolby Audio, and the double-D symbol are trademarks of Dolby Laboratories.

The terms HDMI and HDMI High-Definition Multimedia Interface, and the HDMI Logo are trademarks or registered trademarks of HDMI Licensing Administrator, Inc. in the United States and other countries.

The Wi-Fi CERTIFIED™ Logo is a certification mark of Wi-Fi Alliance®.  
The Wi-Fi Protected Setup™ Logo is a certification mark of Wi-Fi Alliance®.

The Bluetooth® word mark and logos are registered trademarks owned by the Bluetooth SIG, Inc. and any use of such marks by SHARP Corporation is under license. Other trademarks and trade names are those of their respective owners.

ANY USE OF THIS PRODUCT IN ANY MANNER OTHER THAN PERSONAL USE THAT COMPLIES WITH THE MPEG-2 STANDARD FOR ENCODING VIDEO INFORMATION FOR PACKAGED MEDIA IS EXPRESSLY PROHIBITED WITHOUT A LICENSE UNDER APPLICABLE PATENTS IN THE MPEG-2 PATENT PORTFOLIO, WHICH LICENSE IS AVAILABLE FROM MPEG LA, LLC, 6312 S. Fiddlers Green Circle, Suite 400 E, Greenwood Village, Colorado 80111 U.S.A.

THIS PRODUCT IS LICENSED UNDER THE VC-1 PATENT PORTFOLIO LICENSE FOR THE PERSONAL AND NON-COMMERCIAL USE OF A CONSUMER TO (i) ENCODE VIDEO IN COMPLIANCE WITH THE VC-1 STANDARD ("VC-1 VIDEO") AND/OR (ii) DECODE VC-1 VIDEO THAT WAS ENCODED BY A CONSUMER ENGAGED IN A PERSONAL AND NON-COMMERCIAL ACTIVITY AND/OR WAS OBTAINED FROM A VIDEO PROVIDER LICENSED TO PROVIDE VC-1 VIDEO. NO LICENSE IS GRANTED OR SHALL BE IMPLIED FOR ANY OTHER USE. ADDITIONAL INFORMATION MAY BE OBTAINED FROM MPEG LA, L.L.C. SEE [HTTP://WWW.MPEGLA.COM](http://www.mpegla.com)

THIS PRODUCT IS LICENSED UNDER THE AVC PATENT PORTFOLIO LICENSE FOR THE PERSONAL USE OF A CONSUMER OR OTHER USES IN WHICH IT DOES NOT RECEIVE REMUNERATION TO (i) ENCODE VIDEO IN COMPLIANCE WITH THE AVC STANDARD ("AVC VIDEO") AND/OR (ii) DECODE AVC VIDEO THAT WAS ENCODED BY A CONSUMER ENGAGED IN A PERSONAL ACTIVITY AND/OR WAS OBTAINED FROM A VIDEO PROVIDER LICENSED TO PROVIDE AVC VIDEO. NO LICENSE IS GRANTED OR SHALL BE IMPLIED FOR ANY OTHER USE. ADDITIONAL INFORMATION MAY BE OBTAINED FROM MPEG LA, L.L.C. SEE [HTTP://WWW.MPEGLA.COM](http://www.mpegla.com)

THIS PRODUCT IS LICENSED UNDER THE MPEG-4 VISUAL PATENT PORTFOLIO LICENSE FOR THE PERSONAL AND NON-COMMERCIAL USE OF A CONSUMER FOR (i) ENCODING VIDEO IN COMPLIANCE WITH THE MPEG-4 VISUAL STANDARD ("MPEG-4 VIDEO") AND/OR (ii) DECODING MPEG-4 VIDEO THAT WAS ENCODED BY A CONSUMER ENGAGED IN A PERSONAL AND NON-COMMERCIAL ACTIVITY AND/OR WAS OBTAINED FROM A VIDEO PROVIDER LICENSED BY MPEG LA TO PROVIDE MPEG-4 VIDEO. NO LICENSE IS GRANTED OR SHALL BE IMPLIED FOR ANY OTHER USE. ADDITIONAL INFORMATION INCLUDING THAT RELATING TO PROMOTIONAL, INTERNAL AND COMMERCIAL USES AND LICENSING MAY BE OBTAINED FROM MPEG LA, L.L.C. SEE [HTTP://WWW.MPEGLA.COM](http://www.mpegla.com)

Dimensional Drawing

Unit : mm

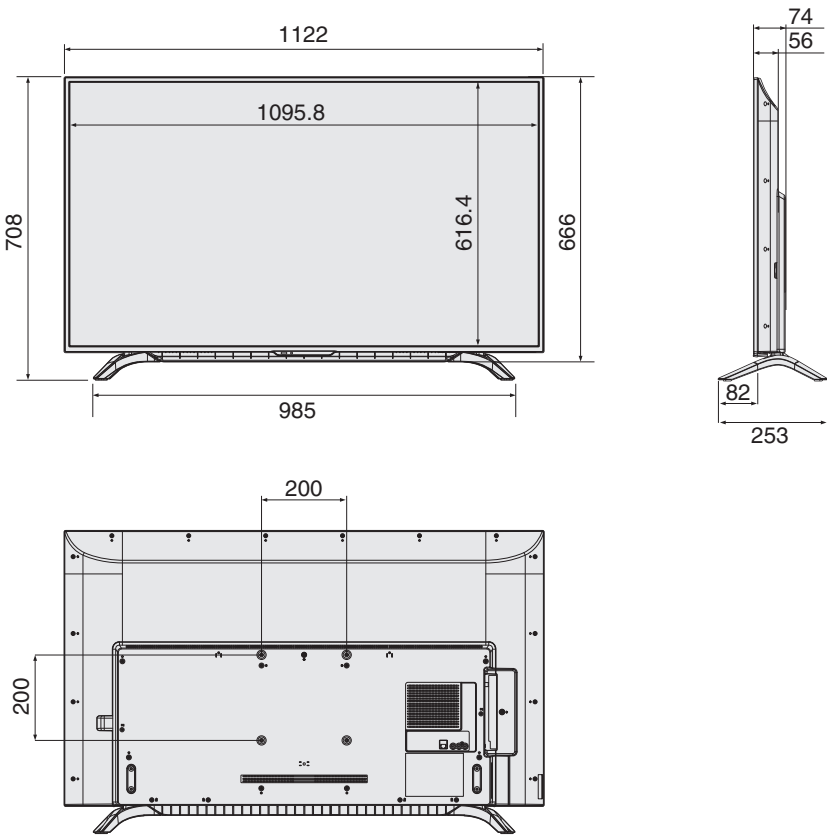

**SHARP®**

SHARP CORPORATION

For Indonesia

NO. REG I.32.STID4.03901.0516

**SHARP®**

**PT. SHARP TRADING INDONESIA**

Kawasan Industri KIIC, Jl. Harapan Raya Lot LL 1 & 2  
Gedung No. 01, Desa Simabaya, Kec. Teluk Jambé Timur  
Kabupaten Karawang 41361