

# SHARP

## Operation Manual

Model:  
PJ-IGS16SG(WH)

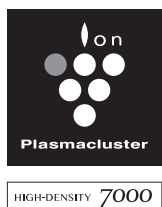

## Plasmacluster Ion Electric Stand Fan (Convertible)

### TABLE OF CONTENTS:

	Page
Parts Identification	1
Features and Maintenance	2
Caution and Safety Precautions	3
Assembly Method	4-5
Specifications and Operating Instructions	6

\* The numbers on this technology mark indicates that the product is placed near the wall operating at its "maximum air volume". Measured from the center of the room (1.2m above the floor) with a common floor area.



Plasmacluster Ion logo and Plasmacluster Ion are registered trademarks of Sharp Corporation in Japan, Philippines, and elsewhere.

Dear Customer,  
Thank you very much for purchasing the Sharp Brand.  
Please read this manual carefully before operating this product. Keep this manual handy for further references.

TJNSE0864PLZZ  
Issue 1 Rev.0

## PARTS IDENTIFICATION

1. Sharp PCI Decal

2. Front Grill

3. Blade Nut

4. Blade

5. Grill Nut

6. Back Grill

7. Front Motor Cover

8. PCI Module

9. Oscillation Knob

10. Rear Motor Cover

11. Speed Indicator Sticker

12. Switch Box Assembly with Knob

13. T-Screw

14. AC Cord

15. Stand Pipe Assembly

16. Plain Base Top

17. Base Bottom

(Counterweight)

18. L-Screw with washer

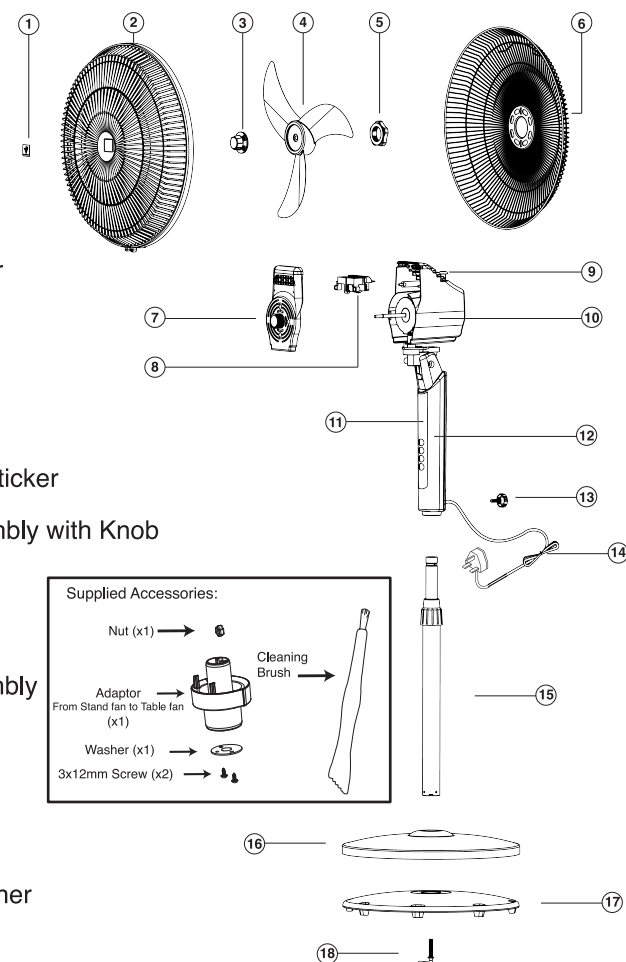

- 1 -

## FEATURES

### What is "Plasmacluster Ion" Technology?

The same plasma and negative ions as those present in nature are created and emitted by plasma discharge. This is an original technology of Sharp that suppresses the actions of viruses and fungi suspended in air. The ions are of the same type as the ions present in nature, and the mechanism of their actions has been understood and their safety has been verified.

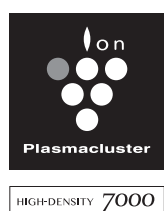

A "Geee" sound is generated when plasmacluster ions are generated, and is not abnormal. Depending on the operating environment and operation mode, the intervals between sounds may change or the sounds may be loud.

Plasmacluster Ions are Generated in all Operating Modes.



## MAINTENANCE

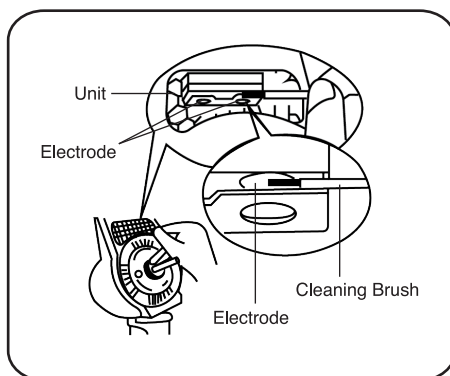

- If dust is attached to the electrode part of the unit remove it with a cleaning brush.
- To clean the blades and the main unit, wipe them off with a cloth dampened with warm water or a neutral detergent, and then wipe them with a soft cloth.
- Dust or water may adhere between the plug and the outlet, so remove the plug and wipe it with a dry cloth before using.

- 2 -

## CAUTION!

1. This product is not to be used by persons (including children) with reduced physical, sensory, or mental capabilities, or lack of experience and knowledge. Unless they have been given supervision or instructions.

2. Children must be supervised not to play with this product.

**WARNING:** If unusual oscillating movement is observed, Immediately stop using the Electric Fan and contact the manufacturer, its service agent, or suitably qualified person.

## SAFETY PRECAUTIONS

1. For safety, switch off unit and unplug from AC mains before cleaning or removing fan.
2. Use this fan with specified voltage as stated on the rating sticker. Make sure the voltage specified corresponds to the AC supply at your house before connecting to main AC.
3. Do not insert finger or other objects into fan when operating.
4. Do not attempt to repair the fan. Always refer to authorized service centers for repairs.
5. Do not immerse the fan in water or other liquids.
6. Do not use outdoors or near windows. Rain drops may cause electrical hazards.
7. If the power cord is damaged, it must be replaced by an authorized service agent or the manufacturer to avoid any hazards.
8. Do not use the following as cleaning solvents: petrol, thinner or benzene.
9. Use mild soap with damp cloth or sponge to clean plastic parts.

- 3 -

ASSEMBLY METHOD

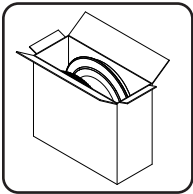

1. Unpack contents from carton box.

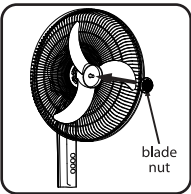

6. Insert the fan blade and the blade nut to the motor shaft.

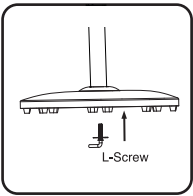

2. Fix the stand pipe assembly into plastic base assembly and tighten by L-screw.

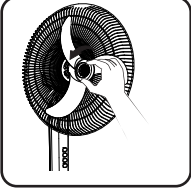

7. Lock the fan blade by turning the blade nut in counterclockwise direction.

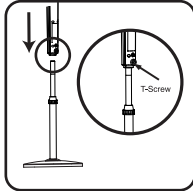

3. Fix the stand pipe assembly into the switch box assembly in correct direction. Ensure the T-screw is properly tightened.

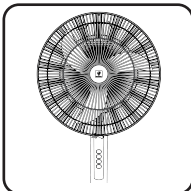

8. Hold the front grill with logo in an upright position and attach to the back grill. Secure it using the snap type ring clip.

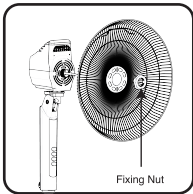

4. Fix the back grill to the motor assembly by matching holes of back grill to the two (2) round pins on the front of the motor assembly.

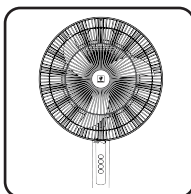

9. Ensure the ring clip is properly snapped.

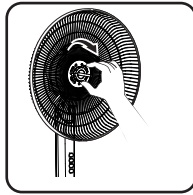

5. Fasten the fixing nut by turning in clockwise direction.

It's now ready to use.

ASSEMBLY METHOD (FROM STAND FAN TO TABLE FAN)

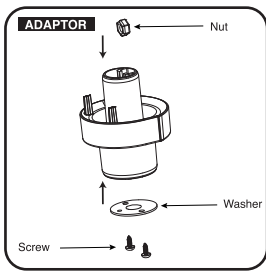

1. Fix the washer in the adaptor using 3x12mm screw. Place the nut in the adaptor as shown in the drawing.

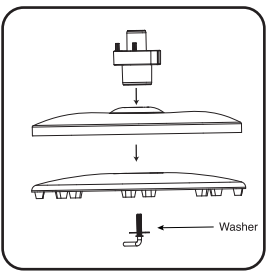

2. Fix the adaptor in the plastic base assembly with counterweight and tighten using the L-Screw with washer.

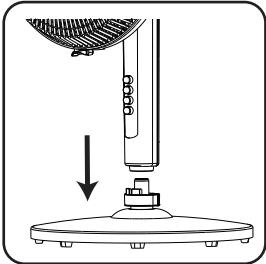

3. Place the switchbox assembly on the adaptor.

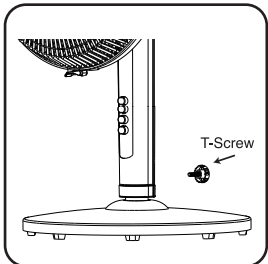

4. Tighten the assembly using the T- Screw

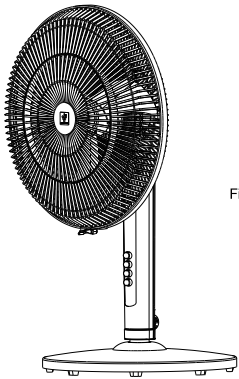

Finished Unit

SPECIFICATION

Model No.: PJ-IGS16SG(WH)

Blade size	Voltage	Power	Speed (RPM)		No. of Running Position	Class of Insulation	Ion Concentration
			Low	High			
16" (40cm)	220 - 240V~ 50/60 Hz	50W	950 RPM	1300 RPM	3	Class B	7000 ions/cm <sup>3</sup>

OPERATING INSTRUCTIONS

1. Plug in the fan to 220 - 240V AC, 50/60 Hz power supply.

2. ON-OFF SETTING

- A. To turn on the unit, select and push numbers 1,2 or 3 depending on your desired speed. The LED indicator light will light up. Plasmacluster Ions are generated in all operating speed.
- B. Push "OFF" to turn the unit off.

3. OSCILLATION

The fan will oscillate during operation when the oscillation knob is in the down position. When the oscillation knob is in the up position, the fan does not oscillate.

4. NECK POSITIONING

To adjust vertical angle, switch off the appliance and tilt angle up or down as needed.