

# SHARP®

## IG-EX20B

### PLASMACLUSTER ION GENERATOR OPERATION MANUAL



HIGH-DENSITY 25000\*

"Plasmacluster" and "Device of a cluster of grapes" are trademarks of Sharp Corporation.



\* The number in this technology mark indicates an approximate number of ions supplied into air of 1 cm<sup>3</sup>, which is measured around the center of a room applicable floor area (at 1.2 m height above the floor) when the product is placed close to a wall at the MED mode setting.

Thank you for purchasing this Plasmacluster ion generator.  
Please read this manual carefully before using the product.  
Please be sure to read "IMPORTANT SAFETY  
INSTRUCTIONS" before using the product.  
This manual should be kept in a safe place for future reference.

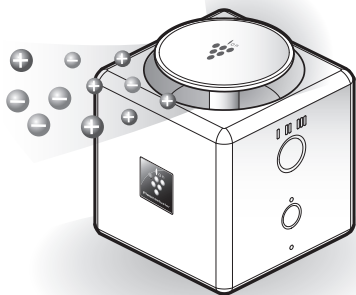

# CONTENTS

---

<b>IMPORTANT SAFETY INSTRUCTIONS .....</b>	<b>2</b>
<b>PART NAMES .....</b>	<b>4</b>
<b>PREPARATION BEFORE USE .....</b>	<b>6</b>
<b>OPERATION .....</b>	<b>8</b>
<b>CARE AND MAINTENANCE / REPLACEMENT.....</b>	<b>9</b>
<b>TROUBLESHOOTING .....</b>	<b>14</b>
<b>SPECIFICATIONS.....</b>	<b>16</b>

## IMPORTANT SAFETY INSTRUCTIONS

Please be sure to follow.

### WARNING

To prevent electric shock, an accident or injury caused by electric leakage or ignition

- **For USB cable, Do not damage it, do not deform it, do not process it, do not bend it forcibly, do not twist it, do not place heavy load on it.**  
(It could cause a damage to the cord and it could cause of a fire and an electric shock.)
- **Do not remove the plug when your hands are wet.**  
(Otherwise, it could lead to electric shock or injury)
- **Do not connect many USB cables to one USB adapter.**  
(Otherwise, it could lead to fire.)
- **Do not use the USB cable if it is damaged or loose.**  
(Otherwise, it could lead to electric shock, short circuit or fire.)
- **Be sure to connect the included USB cable to the PC or USB adapter.** (Otherwise, it could lead to fire, electric shock or malfunction.)
- **Insert the USB cable connection terminal firmly into the PC or USB adapter.** (Otherwise, it could lead to electric shock, smoke or fire.)
- **Periodically remove dust from the USB cable.**  
(Otherwise, it could lead to fire.)
- **Be sure to disconnect the USB cable when cleaning or replacing the unit.** (Otherwise, it could lead to electric shock or injury.)
- **When thunder starts, stop operation and unplug the USB cable.**  
(Otherwise, it could lead to fire, electric shock or malfunction.)
- **If the power cord is damaged, it must be replaced by the manufacturer, its service agent, a Sharp authorized Service Center or similarly qualified persons in order to avoid a hazard. Contact the nearest Service Center for any problems, adjustments or repairs.**
- **Do not apply liquid such as water. When water is applied to the product, remove from the body the USB cable.** (Otherwise, it could lead to heat generating, fire, electric shock or failure.)
- **Do not insert such as a pin or a wire into the air intake or air outlet.** (Otherwise, it could lead to electric shock, injury or abnormal action.)
- **Do not let a child use it by himself/herself.**  
(Otherwise, it could lead to electric shock or injury.)

## CAUTION

To prevent an accident or injury  
such as electric shock and fire

- **Unplug the USB cable when not in use. Also, when plugging and unplugging the USB cable, hold the USB cable plug.**  
(Otherwise, electric shock, electric leakage, or fire due to insulation deterioration is generated.)
- **Do not climb or put anything on the product.**  
(Otherwise, it could cause injury or damage.)
- **When installing the product on the wall, do not pass through or place anything under the product.**  
(Otherwise, it could cause leading to injury or failure.)
- **Do not use the product at the following places:**
  - **Places that are wet or humid, such as bathrooms.**
  - **Where the oil component such as edible oil is floating.**
  - **Places where sprays and chemicals are used, such as hairdressing and beauty salons and laundry shops.**  
(Otherwise, it could cause electric shock or damage.)

### NOTE

- **Do not use fluororesin or silicone-containing products\* near the product.**  
\* Hair care products (split end coatings, hair mousses, hair treatments, etc.), cosmetics, antiperspirants, antistatic agents, waterproofing sprays, polishes, glass cleaners, chemical impregnated cloths, wax, etc.

The fluororesin or silicone could get stuck inside the product, preventing it from producing Plasmacluster ions. If this happens, remove the taint from the electrode section of the Plasmacluster Ion Generating Unit. (Page 12)

- **This product is not designed to be waterproof or moisture-proof. Do not use it in places where it may spill into water or moisture.**

# PART NAMES

## Top / Control panel / Indication

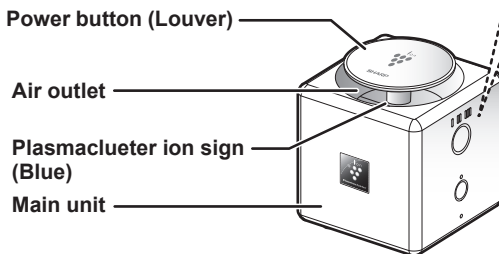
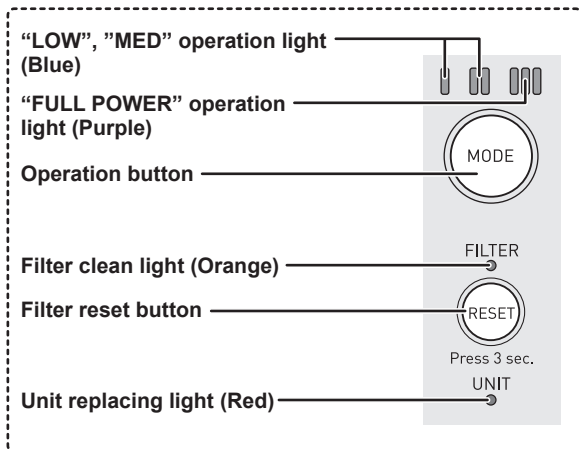

## Bottom / Side / Back

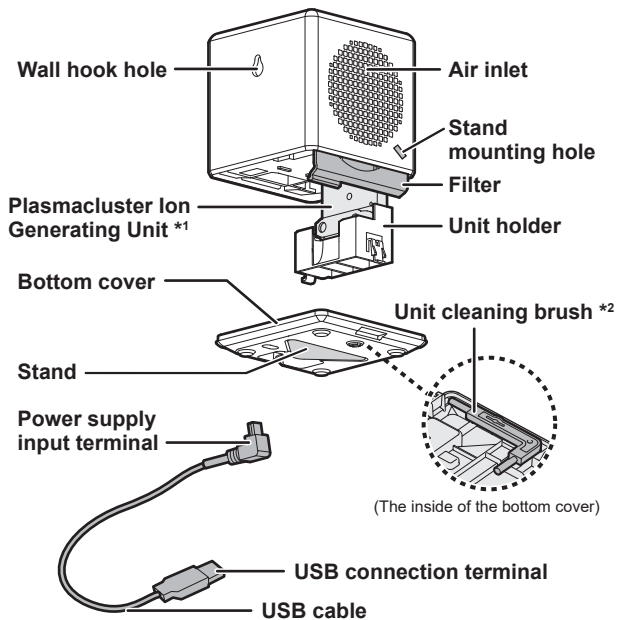

\* 1 Unit means Plasmacluster Ion Generating Unit. (It means the same thereafter.)  
Do not remove except the cleaning of the electrode or exchanging.

\* 2 Do not use the unit cleaning brush, except when you clean the Plasmacluster Ion Generating Unit.

# PREPARATION BEFORE USE

## Precautions on installation

### Please observe the following:

- Be sure to place the product on a stable flat surface.
- When installing the product on the wall, hang the product on a firmly fixed hook. Use a hook with a screw head diameter of 5 mm to 7 mm. When installing on gypsum board, use the gypsum board hook.
- Do not install the product at 120 cm or higher.
- Do not block the air inlet and the air outlet.
- Keep away the product from the TV, the radio or the atomic clock when the TV or the radio are influenced by noise or the atomic clock time is not displayed correctly.
- To use in a room at 0 °C to 35 °C.
- Do not install in a location where it may spill into water or moisture.

### Connecting the USB cable

- **Connecting to a commercially available USB adapter**

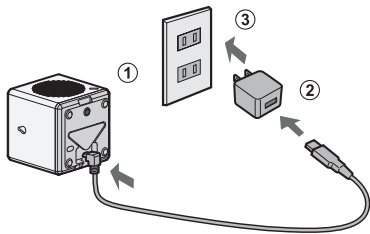

6

- **Connecting to PC**



When connected to a PC, it will operate in conjunction with the PC power ON / OFF.



## Attaching the stand



## How to place the product

- When used in place

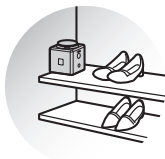

- When hanging on the wall



- It is even more effective to use the air outlet toward a place where odors are a concern.

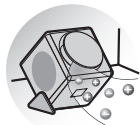

When you use to defeat the product, lay a rug slip under the product to fix the product. (Do not block the air inlet and outlet.)

# OPERATION

## Operation Start / Stop

### Operation Start

Press (Power button raised)

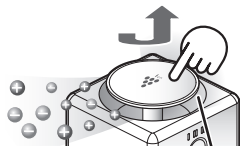

Blue light is emitted

### Stop

Press  
(Power button down state)

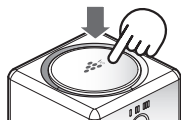

- The product restarts operation in the previously selected mode.

## Operation switching



### If you want to operate the product quietly

≧0≦ (Blue)  
LOW  
Reduce the operation sound and release high-density Plasmacluster ions quietly.

≧00≦ (Blue)  
MED  
Release high-density of Plasmacluster ion more to improve the effect of the Plasmacluster ion.

≧000≦ (Purple)  
FULL  
Release high-density of Plasmacluster ion to approx. 2 times of "MED" at strong flow rate.

### NOTE

- When the product is fixed on the wall, remove it and operate.

# CARE AND MAINTENANCE / REPLACEMENT 1

## Filter clean light / Unit replacing light

### Filter clean light

Filter clean light will be lit after approx. 1 month (approx. 720 hours), when operated 24 hours a day. Once cleaning is completed, then press and hold in the Filter reset button for at least 3 sec. to turn off the Filter clean light. (Page 10, 11)



(2 flashes → Turned off)

### Unit replacing light

If the total operating time passes approx. 17,500 hours (approx. 2 years if the product is operated 24 hours a day), Unit replacing light flashes to notify you of the replacement time of the unit. When you replace with a new unit, the light goes off. (Page 13)

**Total operation time**  
**After about 17,500 hours**

- Please replace.

Flashing  
(Red)



**Total operation time**  
**After about 19,000 hours**

- Operation stops.

Fast flashing  
(Red)



# CARE AND MAINTENANCE / REPLACEMENT 2

## Filter (Air inlet)

About once a month

- 1**
- 1 Unplug the USB cable
  - 2 Vacuum the dust from the air inlet with a vacuum cleaner

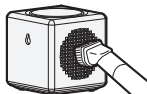
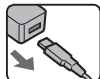

**2**

### Remove the bottom cover

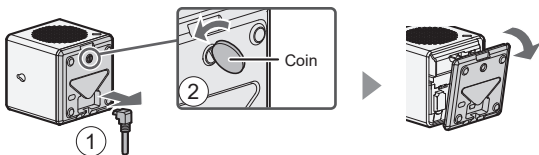

- 3**
- 1 Remove the filter
  - 2 Remove dust with a vacuum cleaner

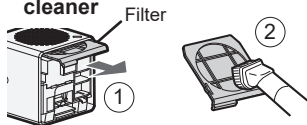

- Do not over-press the filter with the suction port of the vacuum cleaner.
- If the filter is very dirty, wash it with water and dry it in the shade.

**4**

### Attach the filter after cleaning

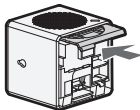

5

### Attach the bottom cover

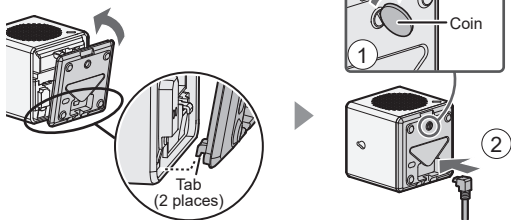

To maintain the ion concentration, clean the filter frequently even if the Filter clean light is not lit. After cleaning, press the Filter reset button for 3 seconds or more.

#### NOTE

- Do not turn on the product while the bottom cover is open.
- If you want to clean it in a place where it is easily scratched, place a cloth under the product.

### Main unit / Air outlet (louver) About once a month

#### Wipe with a soft cloth.

- For stubborn dirt: Use water and a mild detergent. And then, wipe with a wet cloth. Make sure to dry out the main unit.

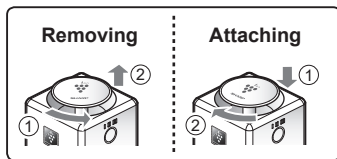

# CARE AND MAINTENANCE / REPLACEMENT 3

Plasmacluster Ion Generating Unit  
(electrode section)

About once every 6 months

- 1**
- 1 Remove the bottom cover. (Page 10)
  - 2 Pull out the unit holder.

Unit holder

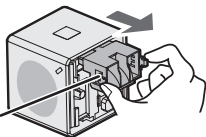

Remove the dust attached to the electrode section of the unit with an included unit cleaning brush or commercially-available cotton applicator.

Electrode section      Unit cleaning brush (Page 5)

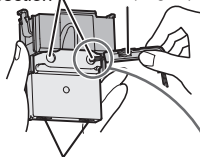

Connection terminals

Electrode (needle)

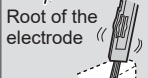

After cleaning

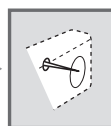

**2**

- 3**
- 1 Inserted securely unit holder to the end.

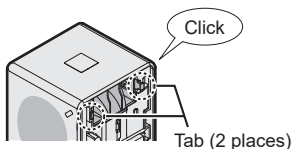
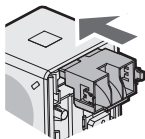

- 2 Attach the bottom cover. (Page 11)

12

## How to replace the Plasmacluster Ion Generating Unit

- 1 Remove the unit holder from the main unit. (Page 12)
- 2 Replace with a new unit.

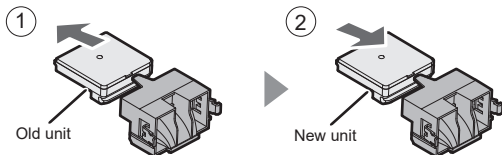

### Replacement Plasmacluster Ion Generating Unit (1 unit)

Model: IZ-C75CE

- Replacement period: approx. 2 years after opening



#### NOTE

#### When caring for the unit

- Do not touch the electrodes.  
(Otherwise, it could lead to injury.)
- Do not transform the electrode section.  
(Otherwise, it could lead to damage.)
- Do not touch the connection terminals.  
(Otherwise, it could lead to damage.)
- If the taint is hard to remove, water a commercially available cotton applicator slightly and wipe off the taint.

#### When replacing a unit

- Please dispose of as garbage do not burn the old unit.  
\* In areas with waste separation rules, follow those rules.

# TROUBLESHOOTING

---

## **Does the Plasmacluster Ion Generating Unit need to be replaced regularly?**

- The Plasmacluster Ion Generating Unit must be replaced regularly in order to maintain the ion density.
- 

## **The Plasmacluster Ion Generator does not work.**

- Is the Power button in the state of OFF? (Page 8)
  - Is a USB cable inserted properly? (Page 6)
  - Is a Plasmacluster Ion Generating Unit inserted correctly? (Page 12, 13)
- 

## **A clicking or ticking sound is heard from the product.**

- Clicking or ticking sound may be audible when the unit is generating ions.  
By use environment and a operation mode, feeling a sound to be big or faint, but there will be no difference in the effect of the Plasmacluster ions.
- 

## **The discharged air has an odor.**

- Filter is getting dirty. Clean the filter.  
After cleaning, press the Filter reset button for 3 sec. or more. (Page 9)
- 

## **Filter clean light (orange) is lighting.**

- Clean the filter and press the Filter reset button for 3 sec. or more. (Page 9, 10, 11)



**Unit replacing light (red) is flashing rapidly, and operation is stopped.**

- It is over the usage period of Plasmacluster Ion Generating Unit.  
Replace with new one. (Page 9, 13)

**Operation lights (“LOW”, “MED” and “FULL POWER”) are flashing simultaneously, and operation is stopped.**

Plasmacluster Ions are not released.

- Is the Plasmacluster Ion Generating Unit installed correctly?  
Remove the unit, fully insert it again and press the Operation button. (Page 12, 13)
- Isn't dust attached to the electrode of the unit?  
Clean the electrode section of the unit. (Page 12)

**Other indication**

- Failure.  
Unplug and contact the store you purchased.

# SPECIFICATIONS

<b>Model</b>	IG-EX20B		
<b>Voltage</b>	USB cable *1		
<b>Rated input</b>	DC5V / 1A		
<b>Applicable floor area*2</b>	Approx. 1.8 m × 0.9 m		
<b>Operation mode</b>	LOW	MED	FULL POWER
<b>Air volume</b>	Approx. 0.05 m <sup>3</sup> /min	Approx. 0.06 m <sup>3</sup> /min	Approx. 0.08 m <sup>3</sup> /min
<b>Power consumption</b>	2.1 W	2.4 W	3.0 W
<b>Current value when using a USB cable</b>	470 mA (max)		
<b>Operating noise</b>	22 dB	25 dB	31 dB
<b>Dimensions</b>	(W) 90 mm (D) 90 mm (H) 95 mm (Excluding USB cable and protrusion of the louver)		
<b>Weight</b>	Approx. 315 g (Excluding USB cable)		
<b>Length of USB cable</b>	Approx. 1.8 m		
<b>Accessories (each 1)</b>	<ul style="list-style-type: none"> <li>●USB cable</li> <li>●Operation Manual</li> </ul>	<ul style="list-style-type: none"> <li>●Unit cleaning brush</li> <li>●Stand</li> </ul>	

\*1 The product does not include a USB adapter.

\*2 The target floor area in which approximately 25000 ions per cubic centimeter can be measured in the center of the room when the product is placed close to a wall, is operating on MED mode, and is at a height of approximately 1.2 meters from the floor.

# MEMO

---



**SHARP®**  
SHARP CORPORATION  
OSAKA, JAPAN

TINSEA008KKRZ 20K- ①

