

MODEL
GX-BP1
WIRELESS **BLUETOOTH**® SPEAKER SYSTEM

OPERATION MANUAL

Thank you for purchasing this SHARP product. To obtain the best performance from this product, please read this manual carefully. It will guide you in operating your SHARP product.



SHARP CORPORATION



92L1050100291A

Printed in China
20D RAS ①

Controls and indicators

Top panel

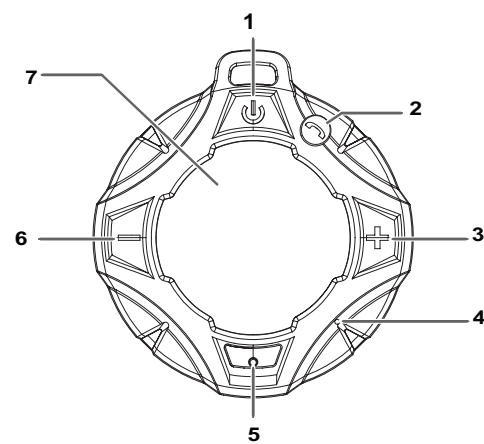

1. Power Button
2. Play / Answer Call Button
3. Volume Up Button
4. Microphone
5. Power / Bluetooth Indicator
6. Volume Down Button
7. Speaker

Bottom panel

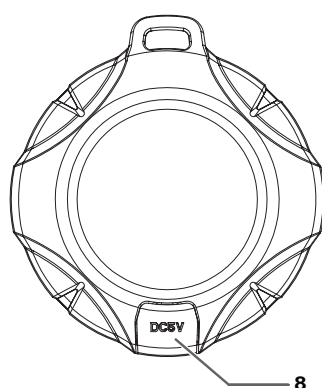

8. Micro USB Charging

E-4

Listening to Bluetooth enabled devices

Bluetooth

Bluetooth wireless technology is a short-range radio technology that enables wireless communication between various types of digital devices, such as mobile phone or computer. It operates within a range of about 30 feet (10 meters) without the hassle of having to use cables to connect these devices.

Notes when using unit with a mobile phone

*Please refer to the operating manual supplied with the mobile phone for details on operation of your mobile phone while transmitting the sound using a Bluetooth connection.

Pairing Bluetooth devices

1. Place the device to be paired within 3 meters of each other when pairing.
2. Press and hold the button to turn the power on. The Power/Bluetooth indicator will blink blue. The speaker is now in pairing mode and is ready to be paired with other Bluetooth source device.
3. Perform pairing procedure on the source device to detect this speaker. "GX-BP1 SHARP" will appear in the detected devices list (if available) in the source device. (Refer the source device operating manual for details).
4. Select "GX-BP1 SHARP" from the source list.
5. Power/Bluetooth indicator (blue) will stop blinking once the speaker is successfully paired with the source device.
6. Press the button to start Bluetooth streaming playback.

E-8

Special Notes

1. Battery information

- A rechargeable battery has a long service life if treated properly. - A new battery or one that has not been used for a long period of time could have reduced capacity the first few times it is used. Do not expose the battery to extreme temperatures, never above 50°C (122°F) or 10°C (below 14°F).
- For maximum battery capacity use the battery at room temperature.
- If the battery is used in low temperatures, the battery capacity will be reduced. The battery can only be charged in temperatures between 10°C (50°F) and 40°C (104°F).
- RISK OF EXPLOSION IF BATTERY IS REPLACED BY AN INCORRECT TYPE. DISPOSE OF USED BATTERIES ACCORDING TO THE INSTRUCTIONS.

2. Removal of waste batteries and accumulators

(Product with embedded battery ONLY)
- In case this product contains a battery incorporated within the product which cannot be readily removed by end users, SHARP recommends that only qualified professionals remove the battery, either for replacement or for recycling at the end of this product's working life. To prevent damage to the product, and for their own safety, users should not attempt to remove the battery and should contact authorized independent service providers for advice.

CAUTION:

Internal lithium battery in the unit should not be replaced by end users due to danger of explosion if battery is incorrectly replaced and must be replaced with the exact type battery by authorized service providers.

The Bluetooth® word mark and logos are registered trademarks owned by Bluetooth SIG, Inc. and any use of such marks by SHARP is under license. Other trademarks and trade names are those of their respective owners.

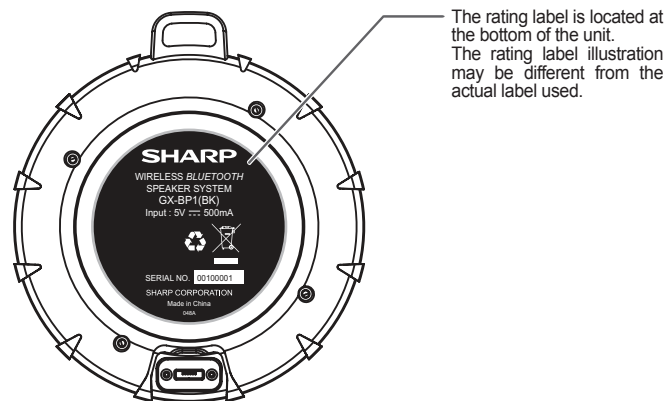

The rating label is located at the bottom of the unit. The rating label illustration may be different from the actual label used.

E-1

Installing the bicycle handlebar bracket

SHARP designed the speaker so you may install on bicycle. See below for installation.

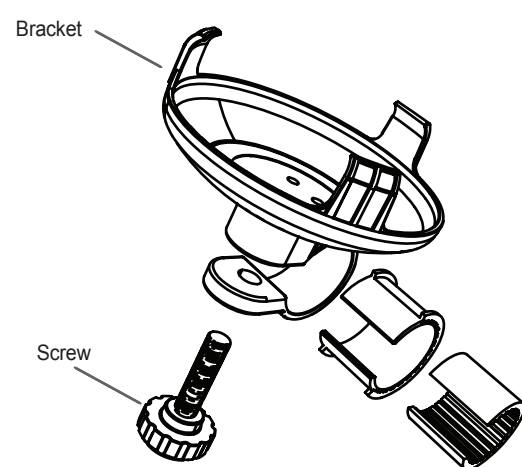

1. Attach the bicycle handlebar bracket to bicycle handle.
2. Fasten the screw.
3. Install the speaker to bracket

E-5

Call functions

Bluetooth

You can receive a call through this speaker when :

- it is connected to a mobile device such as a smartphone via Bluetooth.

About call operation

Function	Operation
Answer a call	Press the .
End a call	Press the .
Decline an incoming call	Press and hold the .
Redial the last called number	Press the twice.

Note:

Some mobile devices do not support the Call Function feature. Thus, this operation may not work.

E-9

Accessories

The following accessories are included.

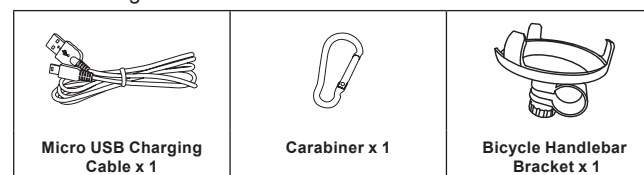

Approved accessories

The use of accessories not approved by SHARP, including but not limited to batteries, antennas, wall adapters, car chargers, ear gels and foam tips and convertible covers, may cause your SHARP device to malfunction or in the case of non-approved electrical accessories may cause the device to exceed RF energy exposure guidelines. Use of non-approved accessories will void your device's warranty.

Electromagnetic interference

Nearly every electronic device is susceptible to electromagnetic interference (EMI) if inadequately shielded, electromagnetic configured for electromagnetic compatibility. Similar to a mobile phone, this unit is a low power transmitter / receiver and is covered by regulations pertaining to such devices. Turn off this unit in any facility where posted notices instruct you to do so. These facilities may include hospitals or health care facilities that may be using equipment that is sensitive to external RF energy.

- When instructed to do so, turn off this unit when on board an aircraft. Any use of a mobile device must be in accordance with applicable laws, regulations and airline crew instructions.
- Some Bluetooth devices may interfere with some hearing aids. In the event of such interference, you may want to consult your hearing aid manufacturer or physician to discuss alternatives.
- If you use any other personal medical device, consult the manufacturer of your device to determine if it is adequately shielded from RF energy. Your doctor or physician may be able to assist you in obtaining this information.
- If you are in doubt about whether this unit be safely turned on or used, please consult an authorized person in the location you want to use it. If no authorized person is available or you remain uncertain, SHARP recommends that you turn off your Bluetooth device and any mobile phones unless they are required in an emergency situation.

E-2

Charging the speaker

1. Open the micro USB charging terminal cover and then connect the micro USB charging cable.
2. Plug the other end of micro USB charging cable into a computer or USB AC adaptor (5V 500mA and above) that is power on.

Note:

When playing the music while charging, please put the volume to a moderate level, otherwise the charger might be unable to afford high current under maximum volume.

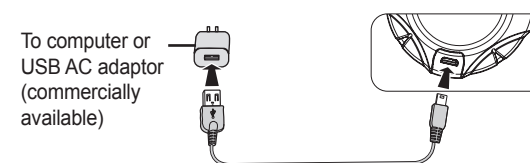

Charging Indication:

Power/Bluetooth Indicator	Red	Turns off
Battery status	Charging	Fully charged

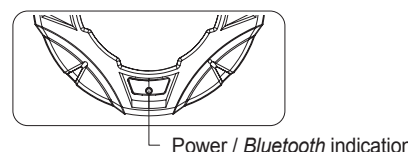

Cautions:

- At extremely high or low temperatures, the battery may not be fully charged.
- To maintain functionality, the device needs to be charged at least once every six months.
- Battery of the device has limited life, as with any other rechargeable batteries.
- Capacity may gradually be decreased over time of which extent may vary depending on the conditions of use and external environment.
- There are multiple factors such as volume level, external environment, etc. that may affect the time of device power turning off, other than the percentage of battery left.
- Use this product only with an agency approved power supply which meets local regulatory requirements (e.g., UL, CSA).
- The equipment shall be connected only to a power supply with limited power source.

E-6

Troubleshooting chart

Many potential problems can be resolved by the owner without calling a service technician. If something is wrong with this product, check the following before calling your authorised dealer or service centre.

General

Symptom	Possible cause
• When a button is pressed, the unit does not respond.	• Turn the unit off and then turn it on again.
• No sound is heard.	• The volume level set to "Min".

Bluetooth

Symptom	Possible cause
• No sound is heard.	• The unit is too far from the Bluetooth audio source device. • The unit is not paired with the Bluetooth audio source device
• Bluetooth sound is interrupted or distorted.	• The unit is too near to a device that generates electromagnetic radiation. • There is an obstacle between the unit and the Bluetooth audio source device.

E-10

Precautions

General

- Do not drop the product from a high place.
- Do not place anything heavy on the unit.
- Do not replace the battery, the unit may explode.
- This device is not a medical device.
- If you have a medical device implanted, contact your doctor before using this unit.
- Keep the unit away from direct sunlight, strong magnetic fields, excessive dust, humidity and electronic / electrical equipment which generate electrical noise.
- Do not expose the unit to moisture, to higher temperatures or to extremely low temperatures.
- Do not repair or disassemble the unit. Refer internal service to your local SHARP service facility.
- No naked flame sources such lighted candles, should be placed on the apparatus.
- Make sure that an infant or a child does not swallow a small components of the product.
- If the unit is exposed to a large amount of sweat, wipe the product clean.
- The apparatus is designed for use in moderate climates.
- Attention should be drawn to the environmental aspects of battery disposal.

Volume control

The sound level at a given volume setting depends on speaker efficiency, location and various other factors. It is advisable to avoid exposure to high volume levels, which occurs while turning the unit on with the volume control setting up high, or while continually listening at high volumes.

E-3

General control

Power on/off

Press and hold the button to turn the power on.

To turn the power off, press and hold the button.

Function

Function	Operation
Play/Pause	Press the .
Volume up	Press the + button to increase volume.
Volume down	Press the - button to decrease volume.
Skip up	Press and hold the + button.
Skip down	Press and hold the - button.

E-7

Specification

As part of our policy of continuous improvement, SHARP reserves the right to make design and specification changes for product improvement without prior notice. The performance specification figures indicated are nominal values of production units. There may be some deviations from these values in individual unit.

General

Output power	5 W (RMS)
Frequency response	20 Hz - 20 kHz
Music play time	Approximately 9 hours at default volume
Charging time	Approximately 2 hours
Rated input voltage	DC 5V 500mA
Operating temperature	0 °C ~ 40 °C
Dimensions	Width: 93 mm Height: 102 mm Depth: 43 mm
Weight	0.19 kg

Bluetooth

Version	V 4.2
Frequency bands	2.402 GHz ~ 2.480 GHz
Maximum power transmitted	<20 dBm

E-11